

ENLARGED PROFILE
ON CENTER LINE OF SIXTEENTH STREET
Scale:— Horizontal— 1"=10'
Vertical— 1"=10'

SHEET No. 3
MAP TO ACCOMPANY APPLICATION
No. [REDACTED]
To CALIFORNIA STATE RAILROAD COMMISSION
For
RAILROAD CROSSING ON SIXTEENTH STREET
AT
ATCHISON TOPEKA AND SANTA FE RAILWAY COMPANY'S
RIGHT OF WAY
In the City of San Bernardino, Calif.
November, 1934
Gordon Stewart
City Engineer

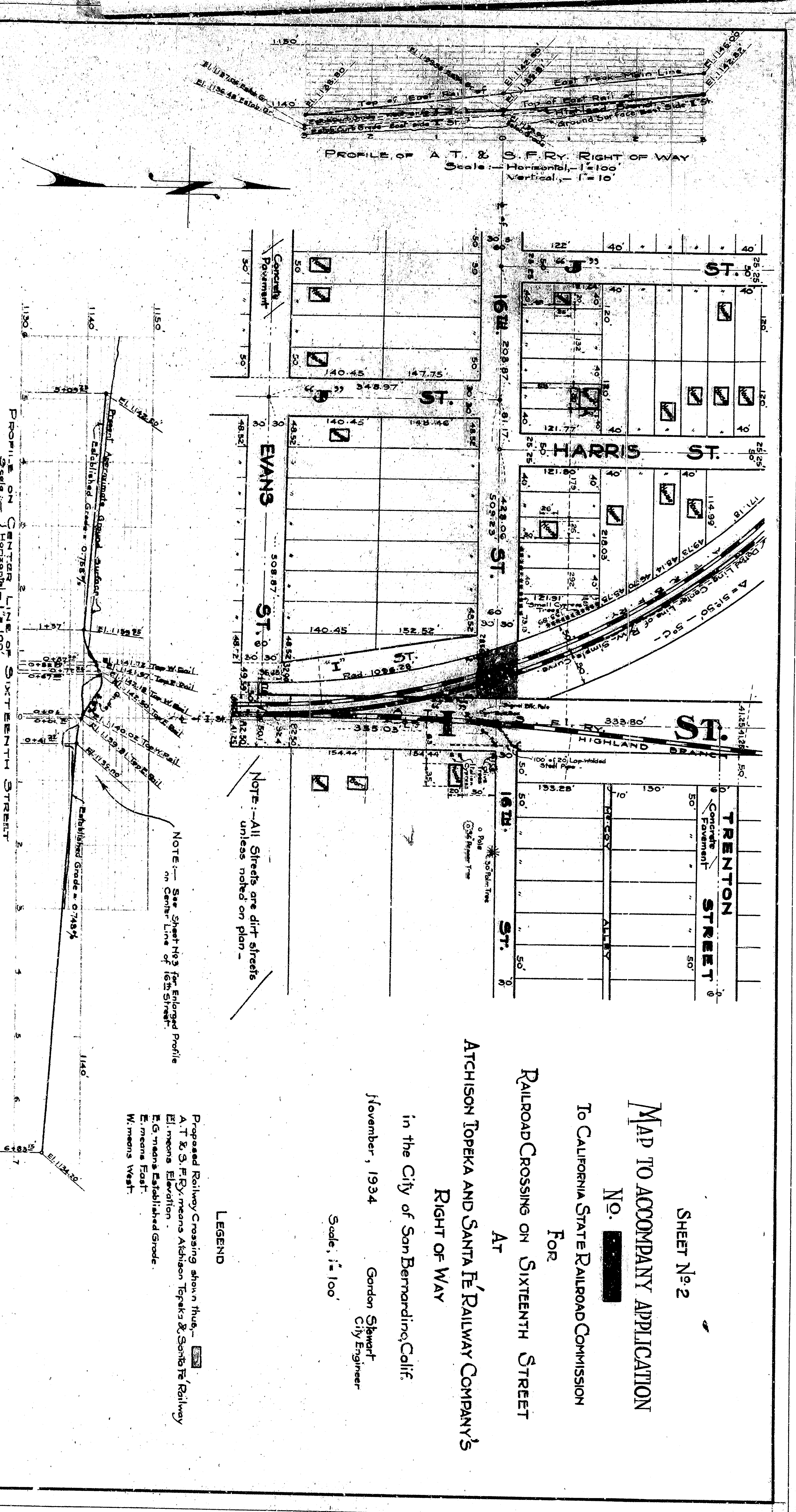

SHEET No. 2
MAP TO ACCOMPANY APPLICATION
No. [REDACTED]
To CALIFORNIA STATE RAILROAD COMMISSION
For
RAILROAD CROSSING ON SIXTEENTH STREET
AT
ATCHISON TOPEKA AND SANTA FE RAILWAY COMPANY'S
RIGHT OF WAY
In the City of San Bernardino, Calif.
November, 1934
Gordon Stewart
City Engineer